

Figure 1: WB-50 ENTERING B BLOCK LOADING AREA FROM SOUTH

Approximate Scale: 1" = 40'
Date: 11/13/2009

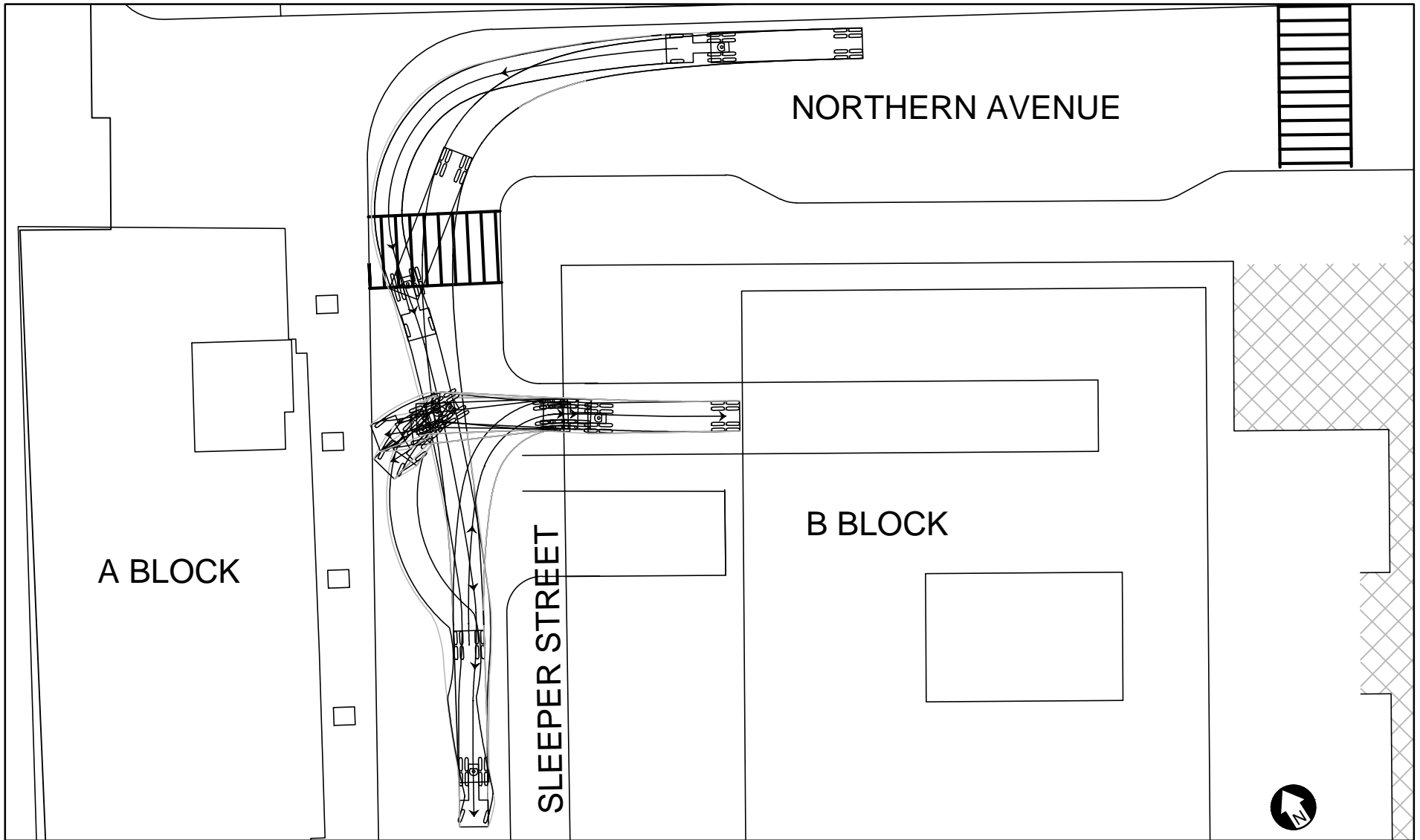

Figure 2: WB-50 ENTERING B BLOCK LOADING AREA FROM NORTH

Approximate Scale: 1" = 40'
Date: 11/13/2009

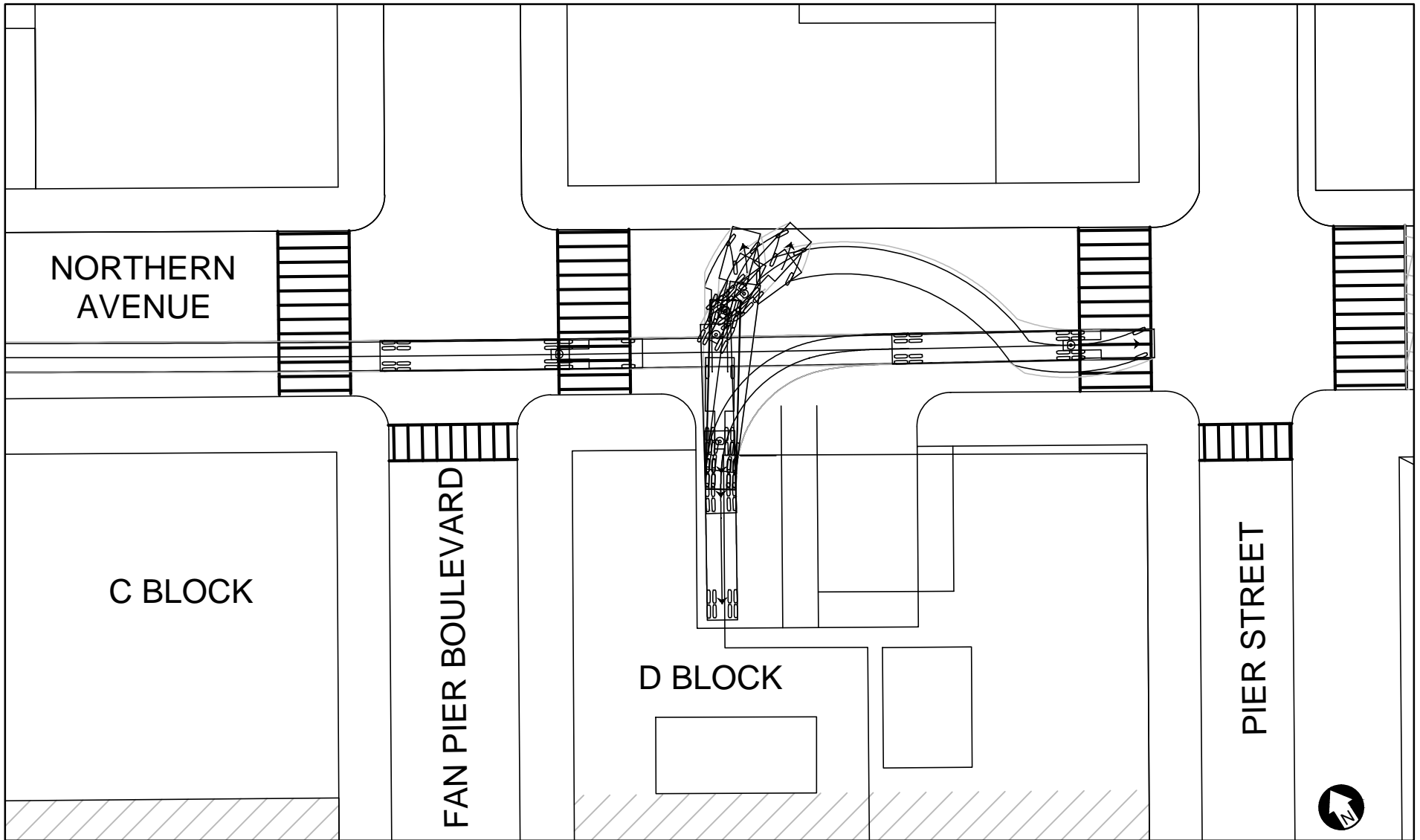

Figure 3: WB-67 ENTERING D BLOCK LOADING AREA FROM WEST

Approximate Scale: 1" = 40'
Date: 11/13/2009

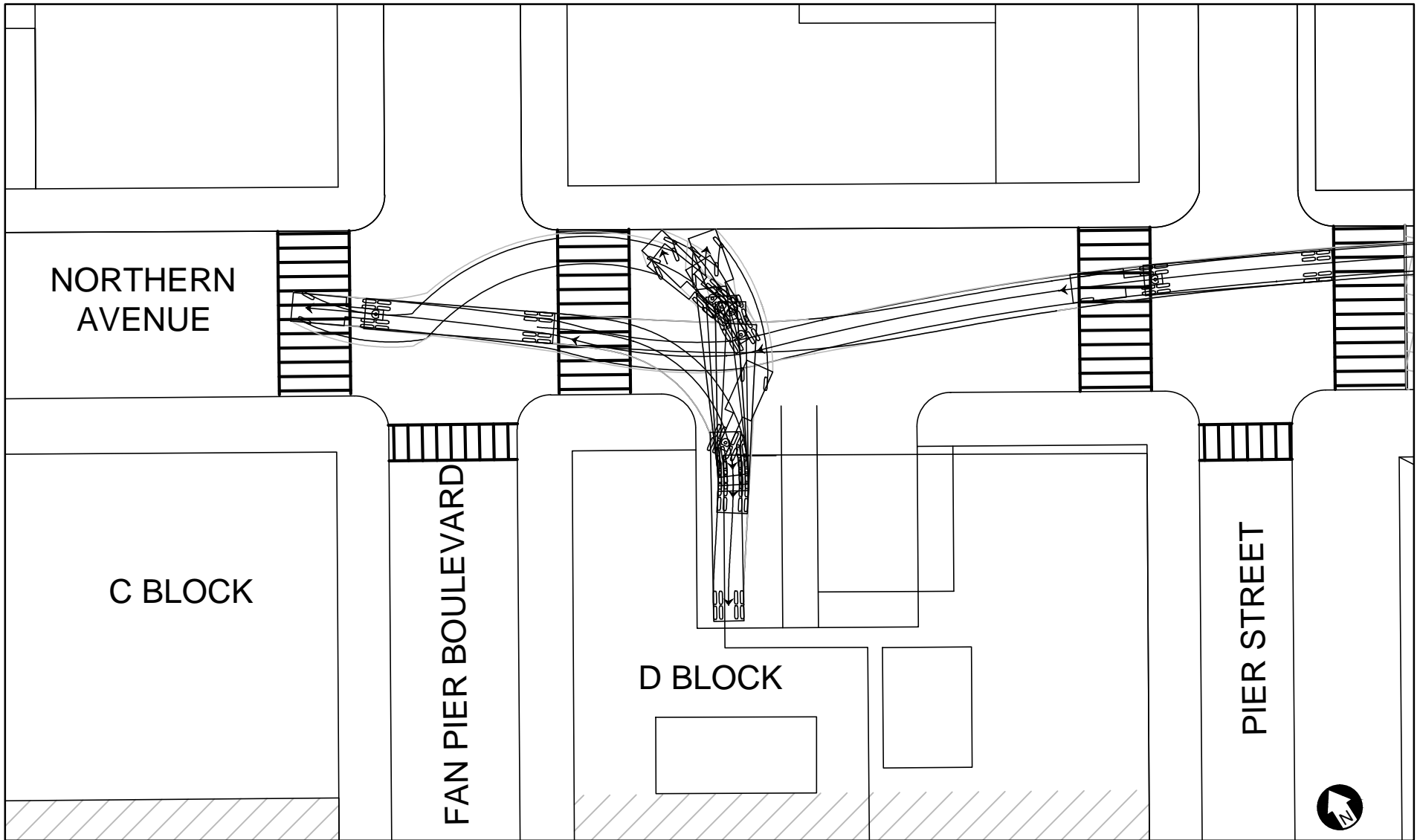

Figure 4: WB-67 ENTERING D BLOCK LOADING AREA FROM EAST

Approximate Scale: 1" = 40'
Date: 11/13/2009

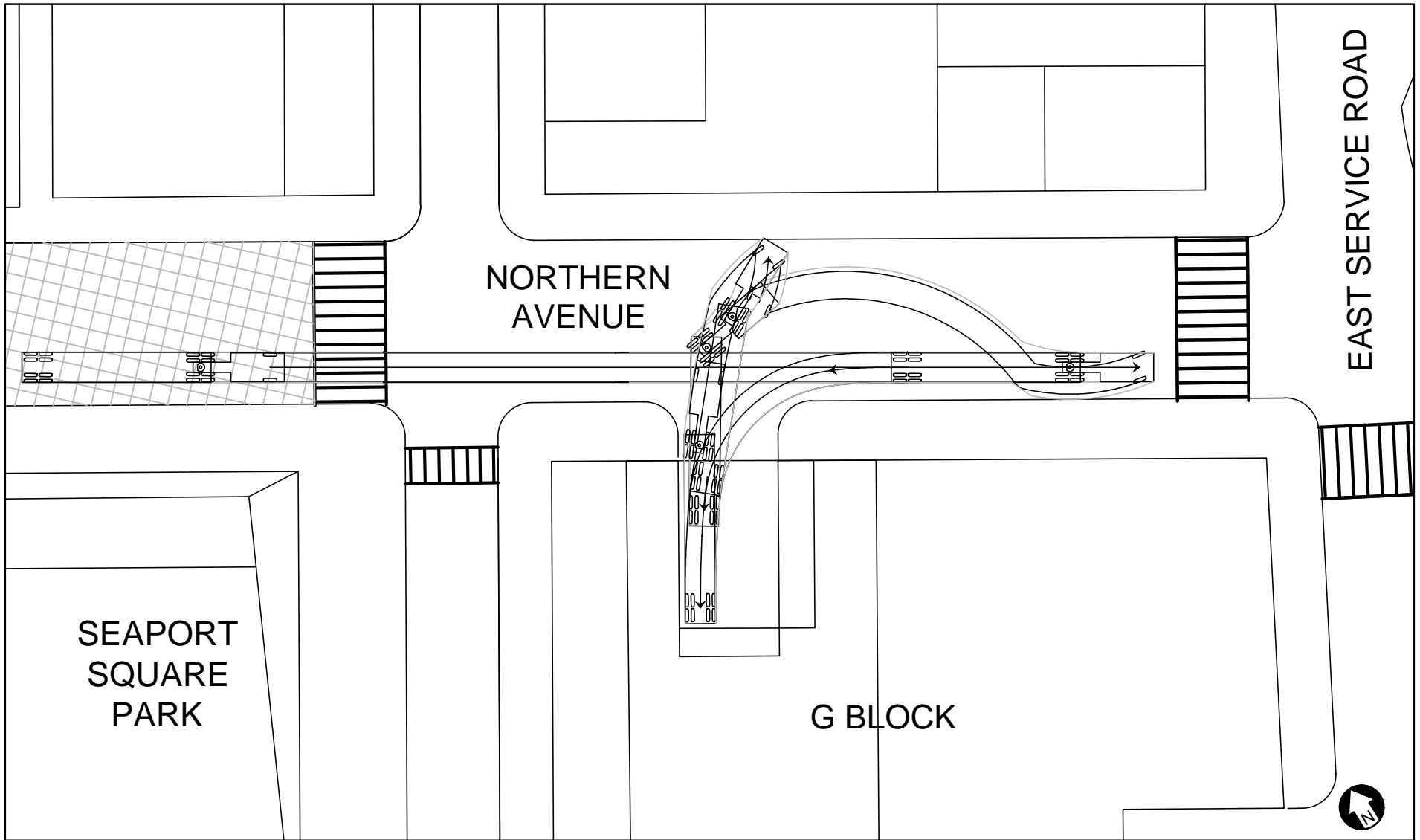

Figure 5: WB-67 ENTERING G BLOCK LOADING AREA FROM WEST

Approximate Scale: 1" = 40'
Date: 11/13/2009

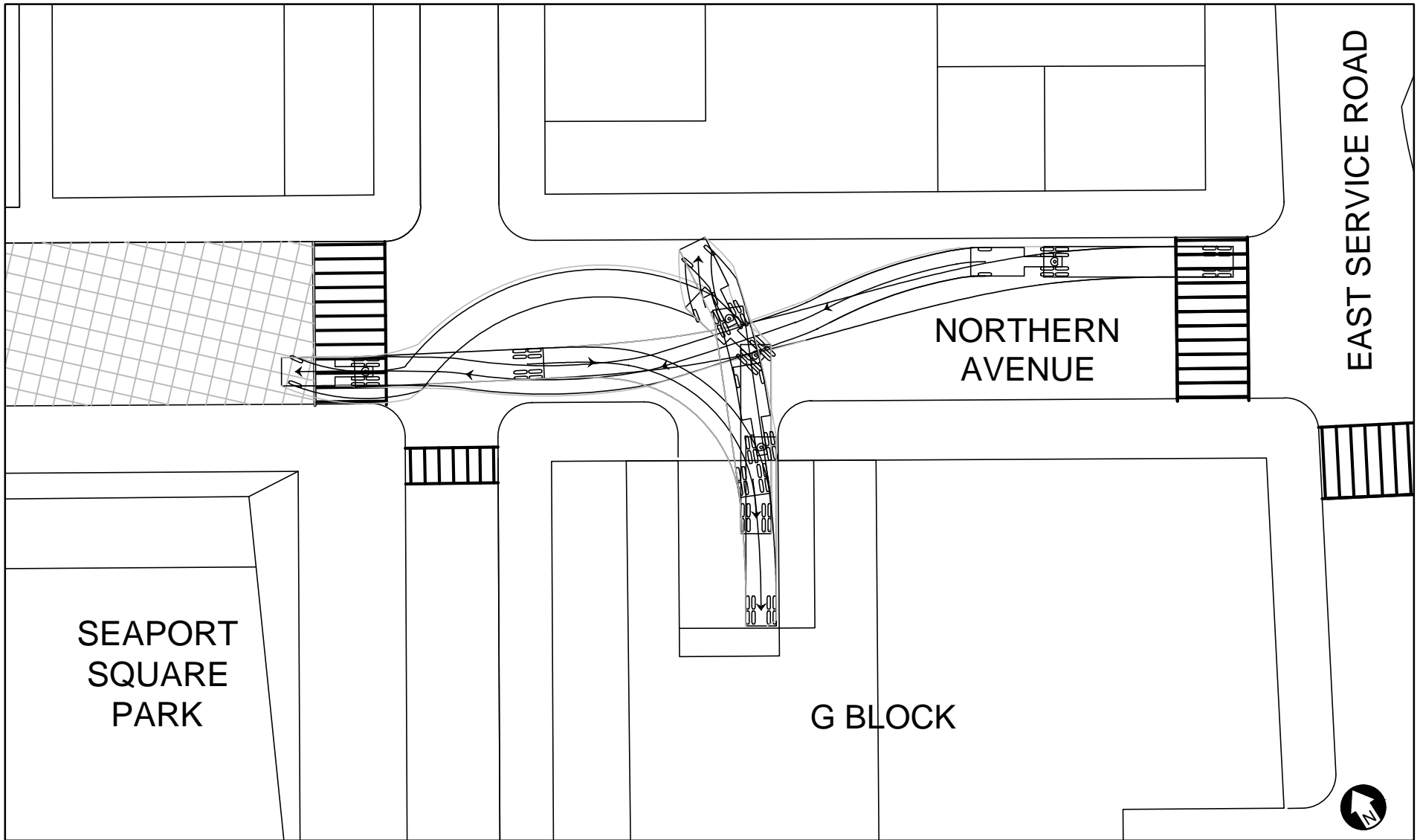

Figure 6: WB-67 ENTERING G BLOCK LOADING AREA FROM EAST

Approximate Scale: 1" = 40'
Date: 11/13/2009

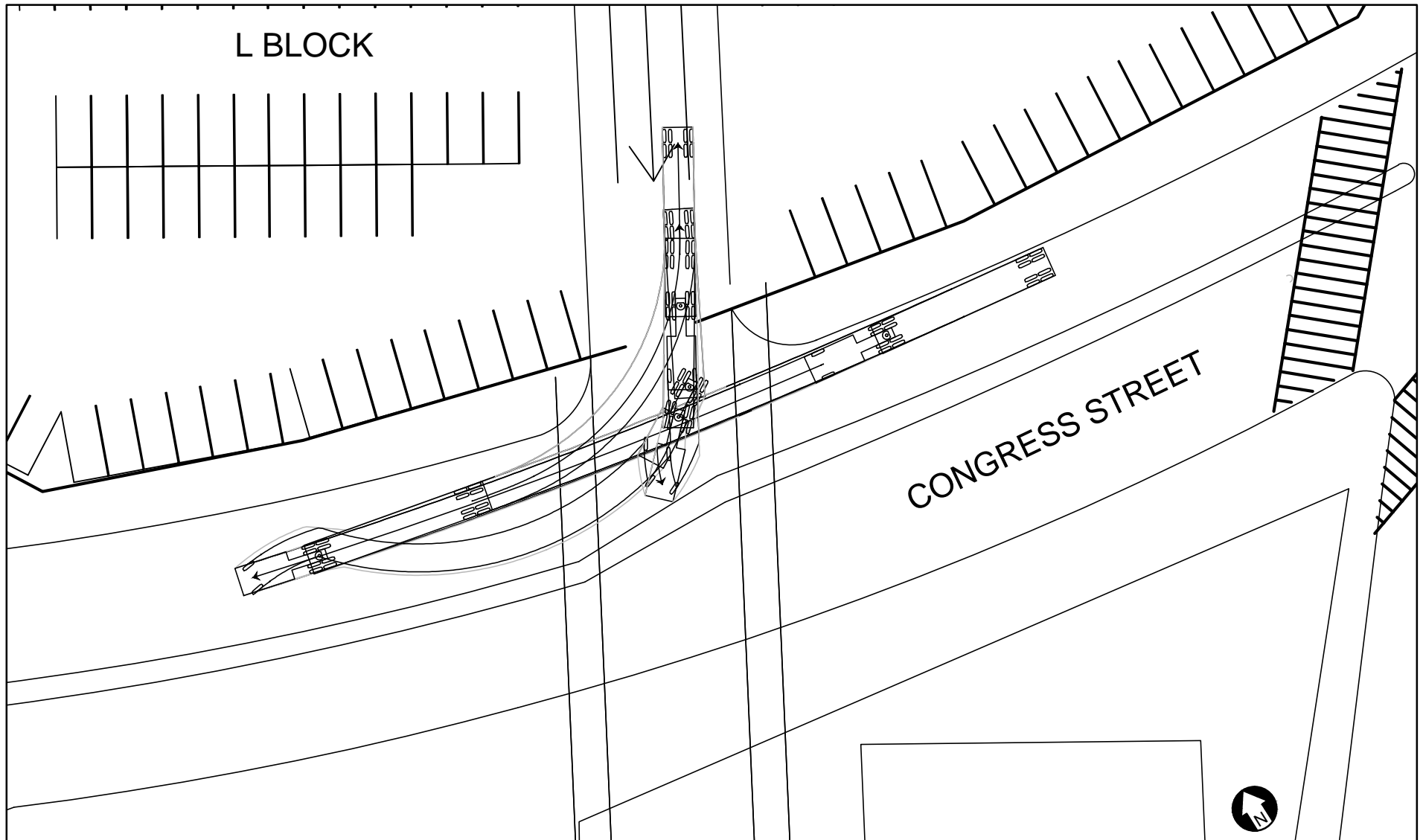

Figure 7: WB-67 ENTERING L BLOCK LOADING AREA

Approximate Scale: 1" = 40'
Date: 11/13/2009

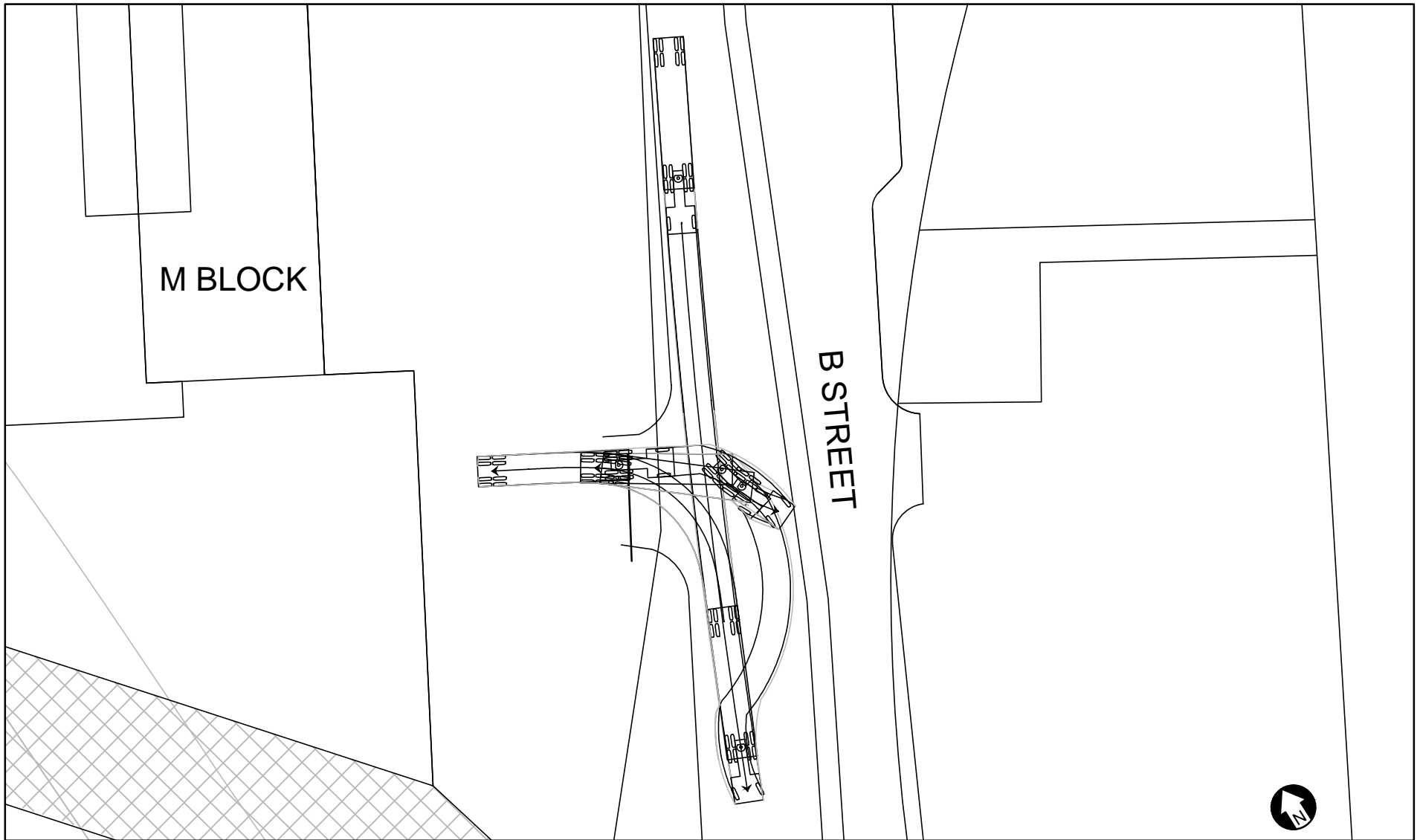

Figure 8: WB-50 ENTERING M BLOCK LOADING AREA

Approximate Scale: 1" = 40'
Date: 11/13/2009

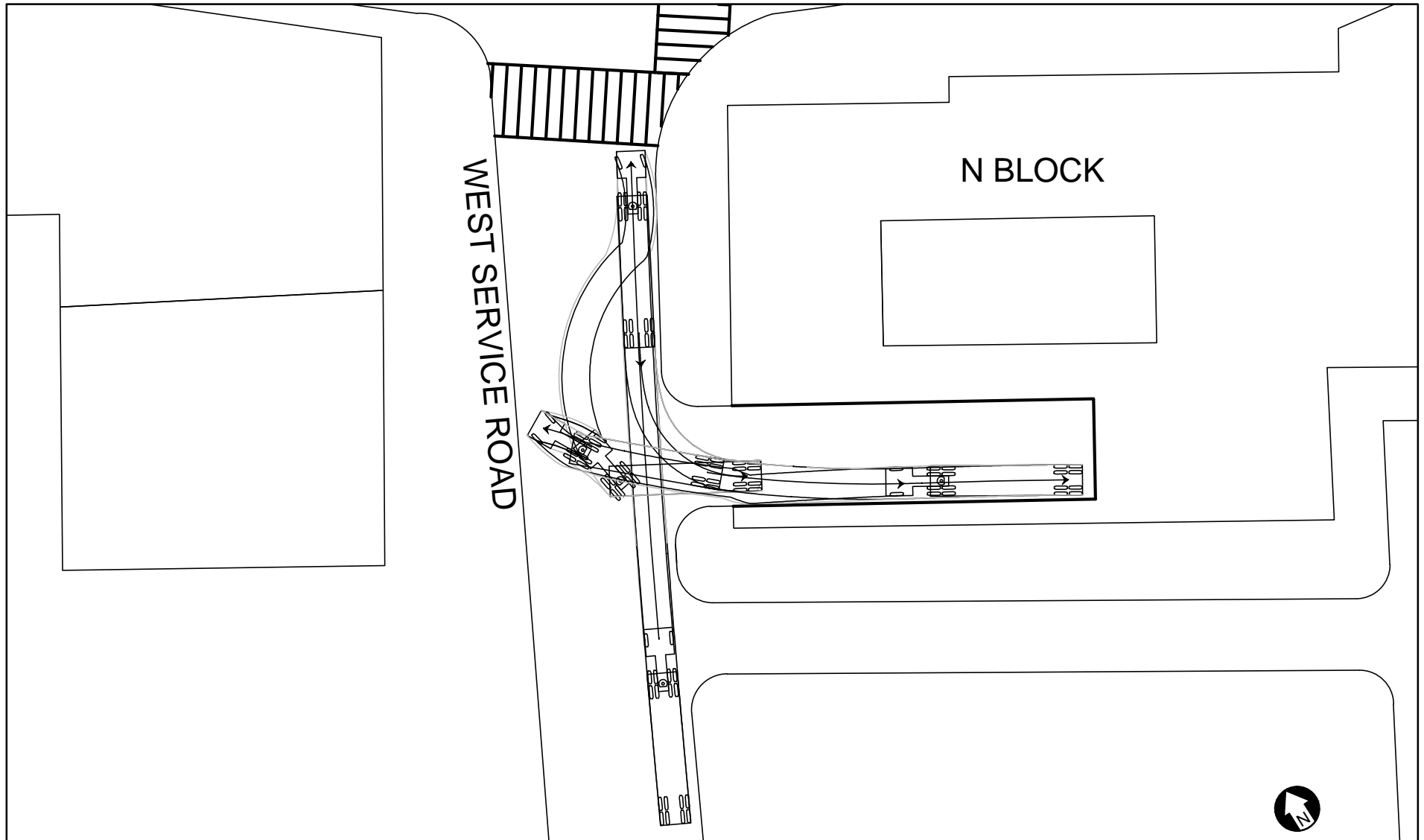

Figure 9: WB-50 ENTERING N BLOCK LOADING AREA FROM SOUTH

Approximate Scale: 1" = 40'
Date: 11/13/2009

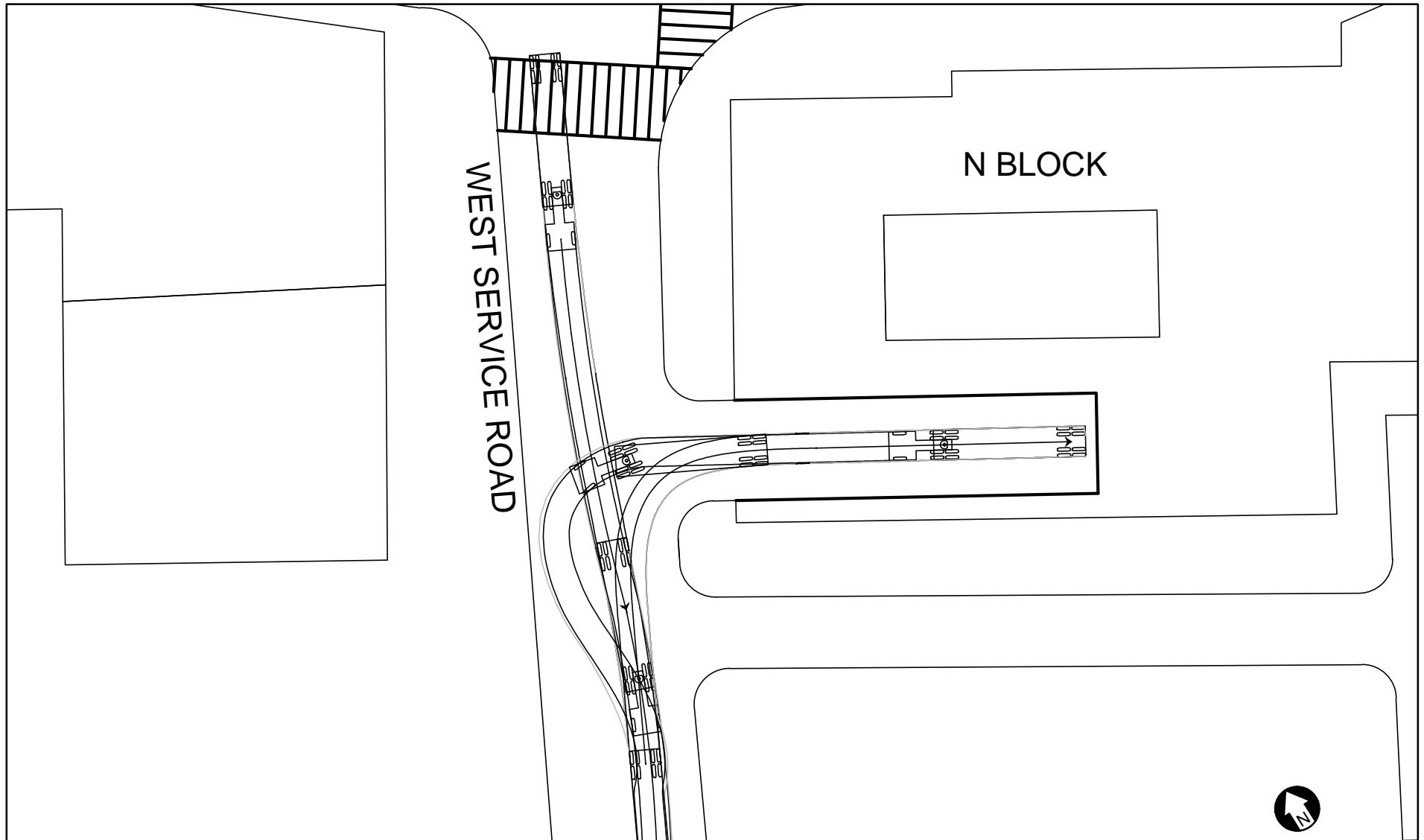

Figure 10: WB-50 ENTERING N BLOCK LOADING AREA FROM NORTH

Approximate Scale: 1" = 40'
Date: 11/13/2009

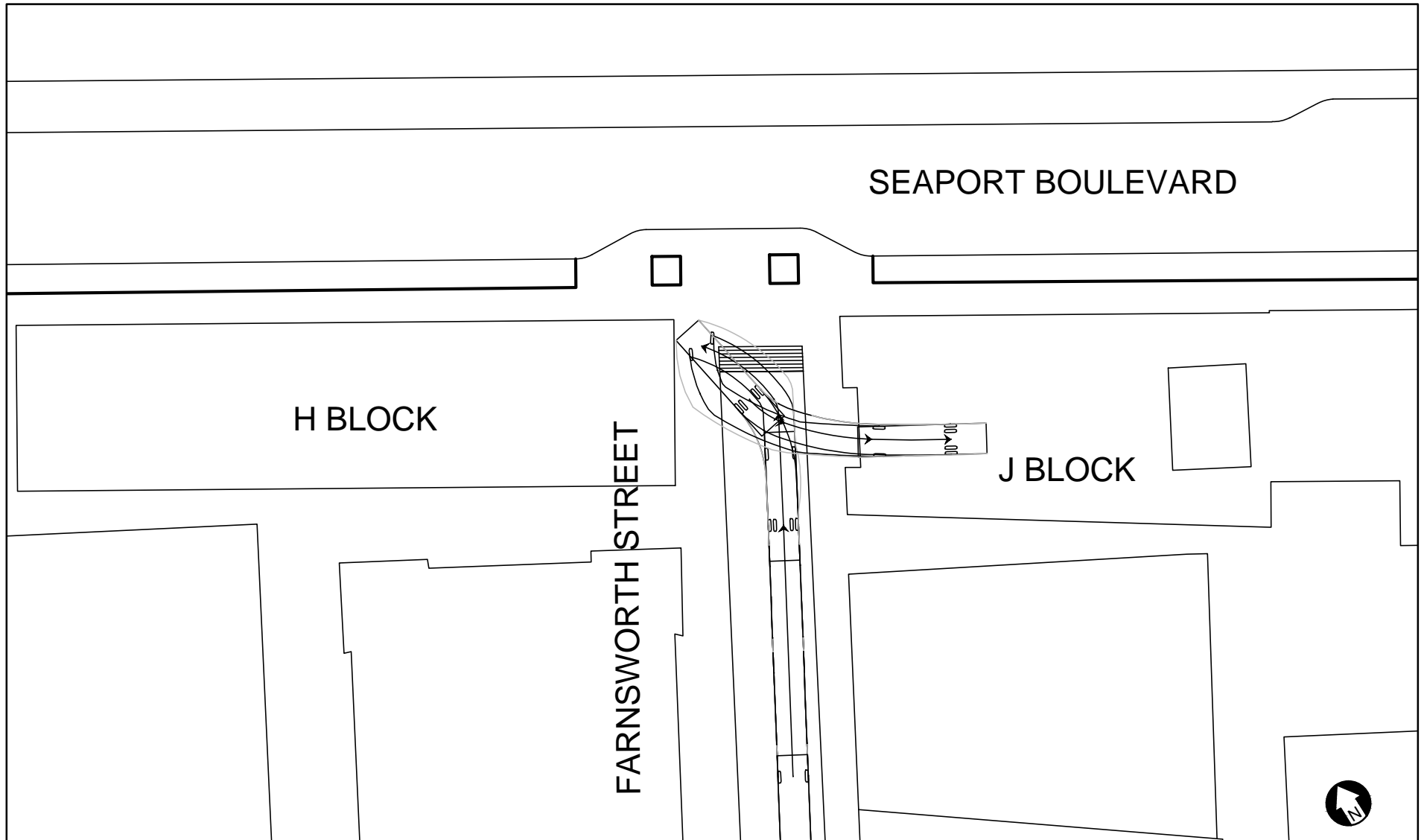

Figure 11: SU-36 ENTERING J BLOCK LOADING AREA

Approximate Scale: 1" = 40'
Date: 11/13/2009

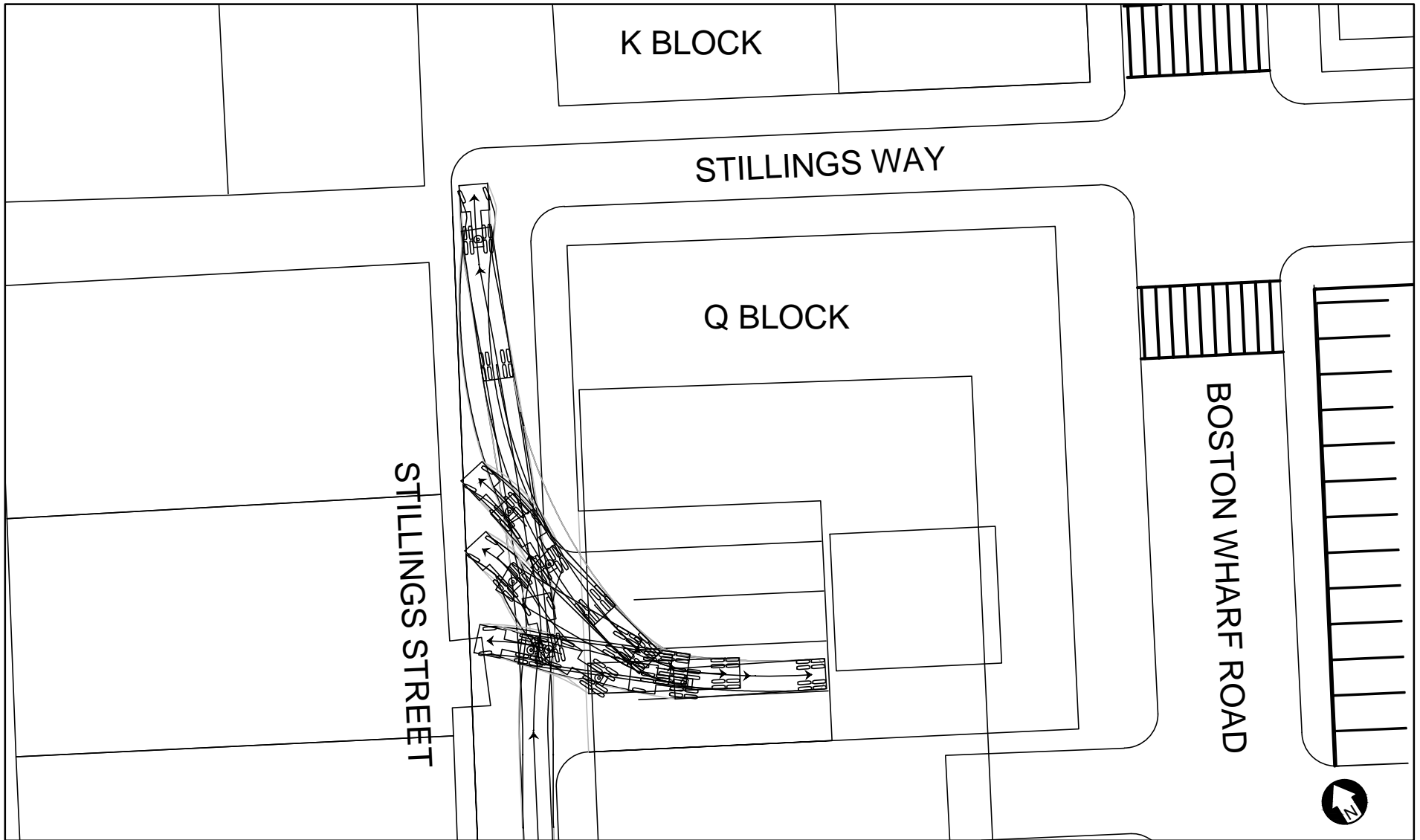

Figure 12: WB-50 ENTERING Q BLOCK LOADING AREA

Approximate Scale: 1" = 40'
Date: 11/13/2009

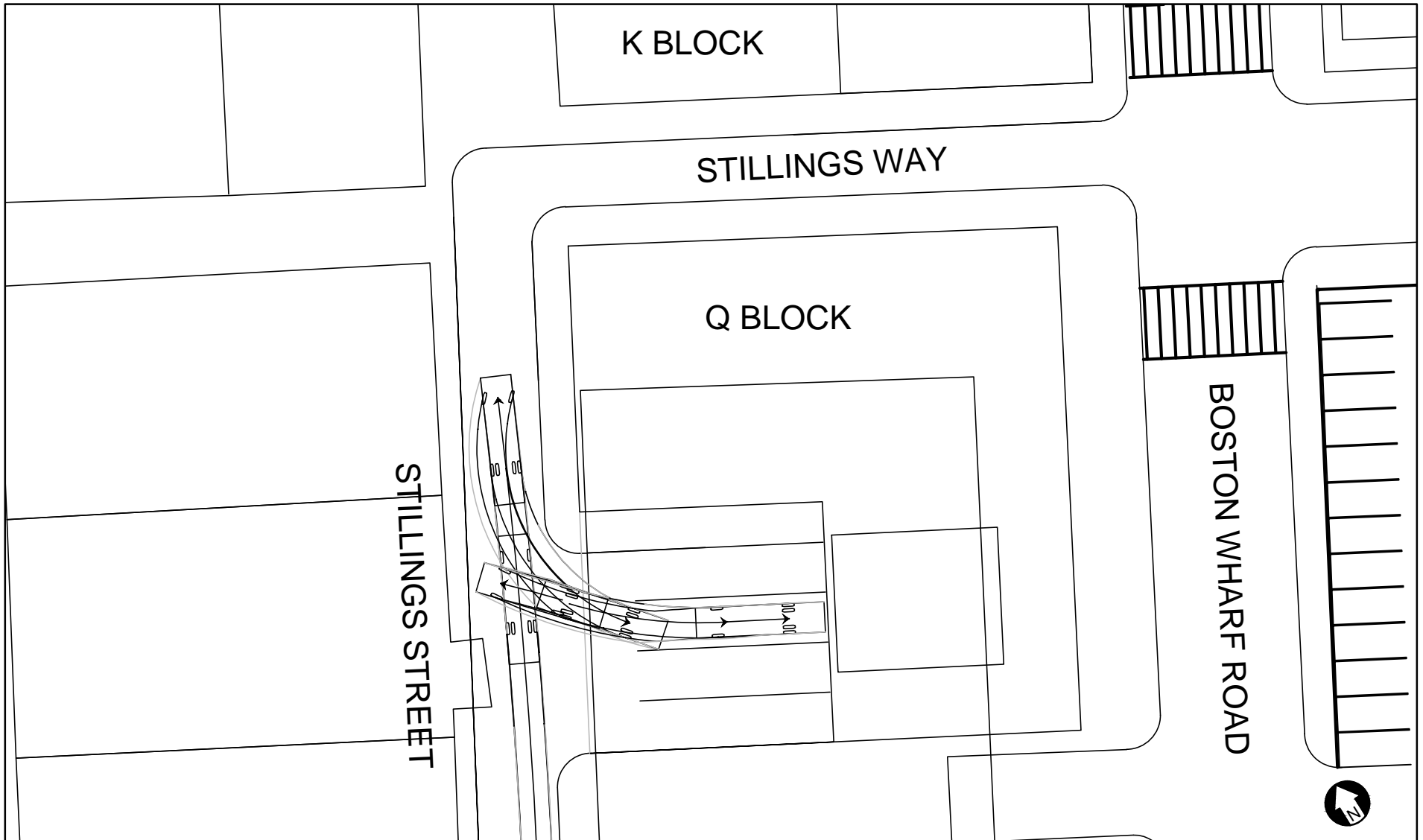

Figure 13: SU-36 ENTERING Q BLOCK LOADING AREA

Approximate Scale: 1" = 40'
Date: 11/13/2009